



# GRC Concrete Panel

**GRC Concrete Panels (GCPs)** are used for decorative exterior and interior facade walls and ideal for minimalist industrial wall design concepts.

Type	Thickness x Width x Length (mm)	Weight (Kg)	Area (m <sup>2</sup> ) per Sheet	Application
Bevel	10 x 600 x 600	6,5	0,36	Decorative Walls
Bevel	10 x 600 x 1200	12,9	0,72	Decorative Walls
Square	10 x 600 x 600	6,5	0,36	Decorative Walls
Square	10 x 600 x 1200	12,9	0,72	Decorative Walls
Round	10 x 600 x 600	6,5	0,36	Decorative Walls
Round	10 x 600 x 1200	12,9	0,72	Decorative Walls



GCP Bevel



GCP Square



GCP Round



Easy to install



Smooth Surface



Light than precast





## GRC Concrete Panel Installation Method

### Application on Frames

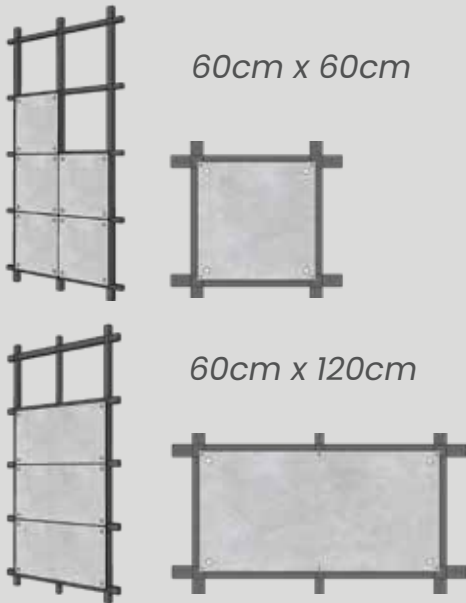

- Use a frame measuring 40 cm × 60 cm or 60 cm × 60 cm, with a minimum thickness of 1.2 mm.
- Fasten with 5 mm GRC screws.
- Fasten from the edge at least 2.5 cm away, and use gray tile grout to cover the screw holes.
- Ensure that the edges meet evenly at the joints.

### Application on Walls

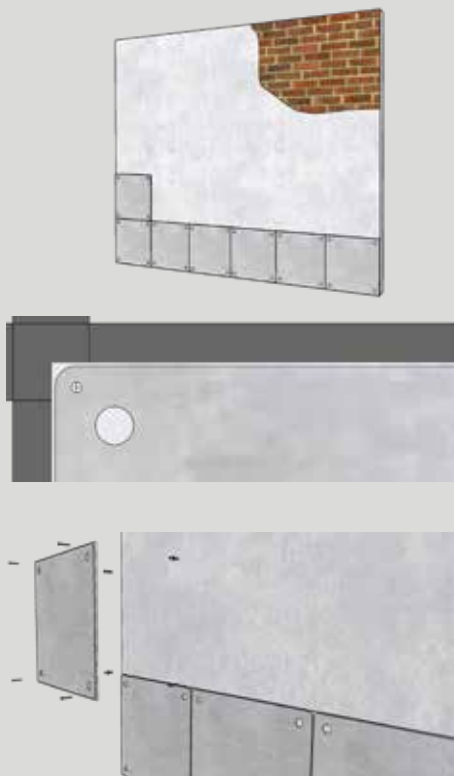

- Ensure that the wall is flat, smooth, and not wavy. Mark the screw points and the placement of plastic plugs/fischer plugs at least 2.5 cm from the edge using a 3 mm concrete drill bit.
- Remove the panel, drill a 3 cm deep hole using a 6 mm concrete drill bit at each marked point on the base, then insert the S6 plastic plug/fischer, and reinstall the GRC Concrete Panel according to the marked points.
- Use gray tile grout to cover the screw holes.
- Ensure the edges meet flush at the joints.



## Bevel





**Square**





## Round





## Bevel





Square





**Round**

